

PAINTING SECTION FLOOR PLAN LAYOUT

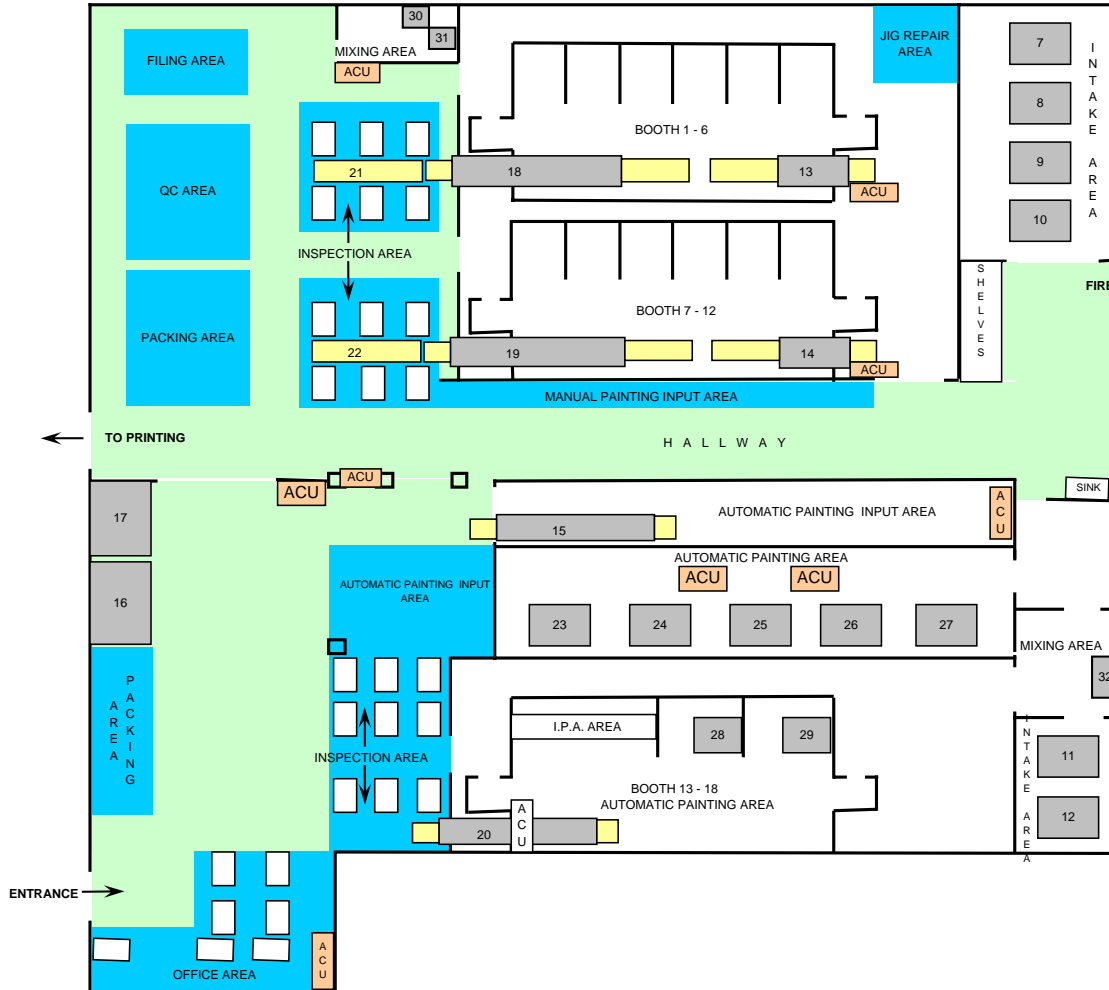

LEGEND	MACHINE / EQUIPMENT NAME	MAKER	ASSET NO. / SERIAL NO.
BOOTH 1 - 6	VENTURI PAINTING BOOTH	ANEST IWATA	Z-J 002 MODEL SVC 40201 / Z-J 002 MODEL SVC 40202
BOOTH 7 - 12	VENTURI PAINTING BOOTH	ANEST IWATA	Z-J 002 MODEL SVC 40203 / Z-J 002 MODEL SVC 40204
BOOTH 13 - 18	VENTURI PAINTING BOOTH	ANEST IWATA	N / A
7	INTAKE MOTOR 1	ANEST IWATA	MODEL DBT8M37 000272
8	INTAKE MOTOR 2	ANEST IWATA	MODEL DBT8M37 000325
9	INTAKE MOTOR 3	ANEST IWATA	MODEL DBT8M37 000271
10	INTAKE MOTOR 4	ANEST IWATA	MODEL DBT8M37 000326
11	INTAKE MOTOR 5	ANEST IWATA	MODEL VPO-8B-SF 33560-4
12	INTAKE MOTOR 6	ANEST IWATA	MODEL VPO-8B-SF 34195-4
13	ANTI - STATIC MACHINE 1	KASUGA DENKI, INC.	NO.10611 BLW-10TD
14	ANTI - STATIC MACHINE 2	KASUGA DENKI, INC.	NO.10612 BLW-10TD
15	ANTI - STATIC MACHINE 3	KASUGA DENKI, INC.	NO.10620 BLW-10TD
16	OVEN #1	STZK INDUSTRY CO. LTD.	SBD-161216-200 / MFG#19707
17	OVEN #2	STZK INDUSTRY CO. LTD.	SBD-161216-200 / MFG#19706
18	DRYER #1	N / A	N / A
19	DRYER #2	N / A	N / A
20	DRYER #3	N / A	N / A
21	CONVEYOR #1	SUHEKKU INDUSTRY CO.	TYPE CV-540 MFG# 110104
22	CONVEYOR #2	SUHEKKU INDUSTRY CO.	TYPE CV-540 MFG# 110102
23	AUTOMATIC PAINTING MACHINE #1	KRJ	KRJ - 002
24	AUTOMATIC PAINTING MACHINE #2	KRJ	KRJ - 001
25	AUTOMATIC PAINTING MACHINE #3	KRJ	KRJ - 005 - 01
26	AUTOMATIC PAINTING MACHINE #4	KRJ	KRJ - 005 - 02
27	AUTOMATIC PAINTING MACHINE #5	KRJ	KRJ - 005 - 03
28	AUTOMATIC PAINTING MACHINE #6	HIROSAKI MACHINE DEVELOPER CORP	NO. 5007
29	AUTOMATIC PAINTING MACHINE #7	HIROSAKI MACHINE DEVELOPER CORP	NO. 5006
30	JIG WASHING MACHINE #1	TACMINA CORP.	00110698 MODEL DL 25 FA-TTT
31	JIG WASHING MACHINE #2	TACMINA CORP.	00110697 MODEL DL 25 FA-TTT
32	THINNER RECYCLING MACHINE	N / A	
ACU	AIR CONDITIONING UNIT	N / A	

prepared by:
Ray Rafanan